

Bobtail Hose End Valves and Adapters

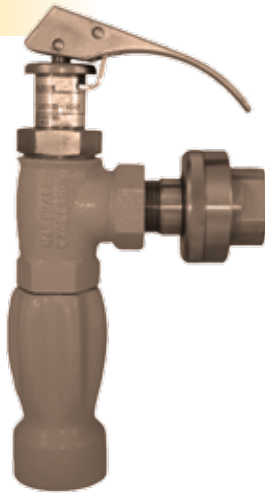

ME800G

ME800GWS

Marshall Excelsior manufactures a number of hose end valves with different features. Models containing the letter "C" in the part number have a durable lightweight black composite handle which limits frosting and transfer of cold to the operators hands during filling operations. Models containing the letter "G" have a fluted handle configuration which makes handling the hose end valve easier. Those valves denoted with a "WS" in the number have an E-Z Turn stainless steel hose swivel mounted to the inlet which allows the valve to rotate 360° for ease of connecting and disconnecting, which can extend hose life by eliminating twisting during winding and unwinding from the hose reel. All Marshall Excelsior 800 series hose end valves have a minimum bleed feature with less than 50cc loss of product at disconnect.

Fisher Controls Hose End Valve.

The Fisher N480 hose end valve is intended for quick opening and closing during truck delivery of LP Gas or NH3. A 45° angle body gives maximum handling ease during the transfer operation. The N480 includes the M570 fillin hose adaptor, which permits the hose end valve to be removed from filler valves that fail to close. The type N481 hose end valve is without the M570 and can be used for NH3 applications.

Sqibb-Taylor Hose End Valve.

Intended for LP Gas hose end service, these quick acting shutoff valves are available in globe or angle body styles. A special locking clip minimizes the chance of accidental opening.



N480



AL343

Sqibb Taylor

ME574EXTHD



ME574EXT



ME578



Hose End Valves

Part Number	Inlet/Outlet	Grip Handle	Manufacturer
ME800G	1 3/4" F.Acme x 1" FNPT - Angle	Fluted Handle - Cast Aluminum	Marshall Excelsior
ME800GC		Fluted Handle - Black Composite	Marshall Excelsior
ME800GCWS		Fluted Handle - Black Composite	Marshall Excelsior
ME800GWS		Fluted Handle - Cast Aluminum	Marshall Excelsior
ME800EXT ¹		Standard Handle - Cast Aluminum	Marshall Excelsior
AL343		Cast Aluminum	Sqibb-Taylor
N480 ²		Cast Steel	Fisher

- ME800EXT has 6" of additional length for underground tank filling
- N480 comes with the M570 hose end adaptor attached as one unit



Swivel Connectors, Hose End Adapters



JOI

Swivel Connectors

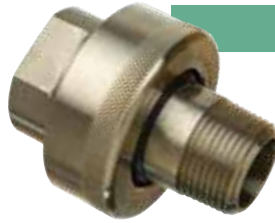

ME850SS-8

SWIVEL CONNECTORS



Squib Taylor

ALI09

Part No	Description	Service	Body Style	Manufacturer
ME850SS-6	3/4" FNPT x 3/4" MNPT	LP and NH3	Straight Through	Marshall Excelsior
ME850SS-6/8	3/4" MNPT x 1" MNPT	LP and NH3	Straight Through	Marshall Excelsior
JOI	1" FNPT x 1" MNPT	LP Only	Straight Through	Full Circle
ALI09	1" FNPT x 1" MNPT	LP and NH3	Straight Through	Squibb Taylor
ME850SS-8	1" FNPT x 1" MNPT	LP and NH3	Straight Through	Marshall Excelsior
ME850SS-8/6	1" FNPT x 3/4" MNPT	LP and NH3	Straight Through	Marshall Excelsior
SMAC114	1 1/4" x 1 1/4" FNPT	LP Only	90° Angle	Full Circle
SMAC112	1 1/2" x 1 1/2" FNPT	LP Only	90° Angle	Full Circle
SMAC112ST	1 1/2" x 1 1/2" FNPT	LP Only	Straight Through	Full Circle
SMAC200	2" x 2" FNPT	LP Only	90° Angle	Full Circle
SMAC200ST	2" x 2" FNPT	LP Only	Straight Through	Full Circle

Repair kits available for all units. Call for details



bergquistinc.com | 800 537 7518



ME570



ME572



ME574



M570



Hose End Valve Adapters



Part Number	Description
ME570	1 3/4" F.Acme x 1 3/4" M.Acme - Solid - No Swivel
ME571	1 3/4" F.Acme x 1 3/4" M.Acme - Internal Swivels
ME572	1 3/4" F.Acme x 1 3/4" M.Acme - Swivels
ME574	1 3/4" F.Acme x 1 3/4" M.Acme - Swivels with Bleeder
ME574EXT	1 3/4" F.Acme x 1 3/4" M.Acme - Extended Tube with Bleeder - Swivels
ME574EXTHD	1 3/4" F.Acme x 1 3/4" M.Acme - Heavy Duty Extended Tube - Swivels
ME578	1 3/4" F.Acme x 1 3/4" M.Acme - Flow Max Manual Locking Closure - Swivels
M570	1 3/4" F.Acme x 1 3/4" M.Acme - Solid - Swivels
Repair Parts	
T13098	Exterior Ring for Fisher M570
T13103	Interior Washer (Gasket) for Fisher M570
ME578-02	Replacement Key for ME578